

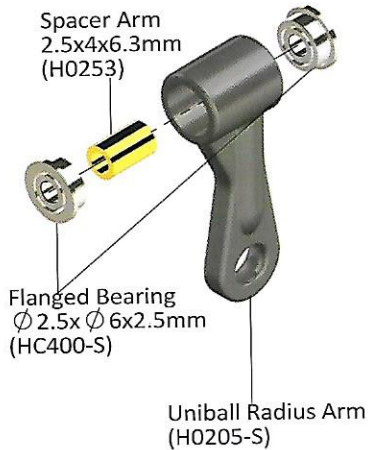

SAB HELI DIVISION

Tray 1, Bag 4

Uniball Radius Arm ... x 2 Assembly



Radius Arm ... x 2 Assembly



Center Hub Assembly

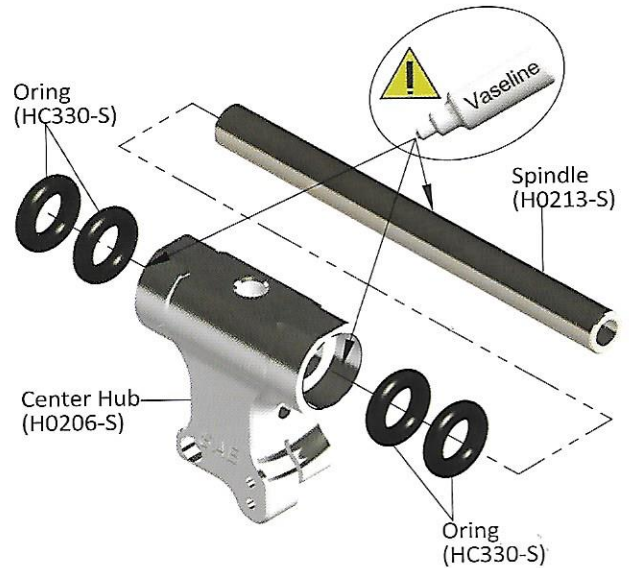

Main Blade Grip Assemblyx2

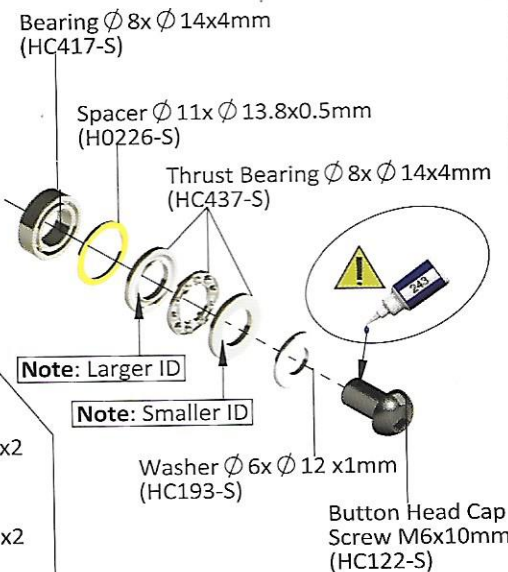
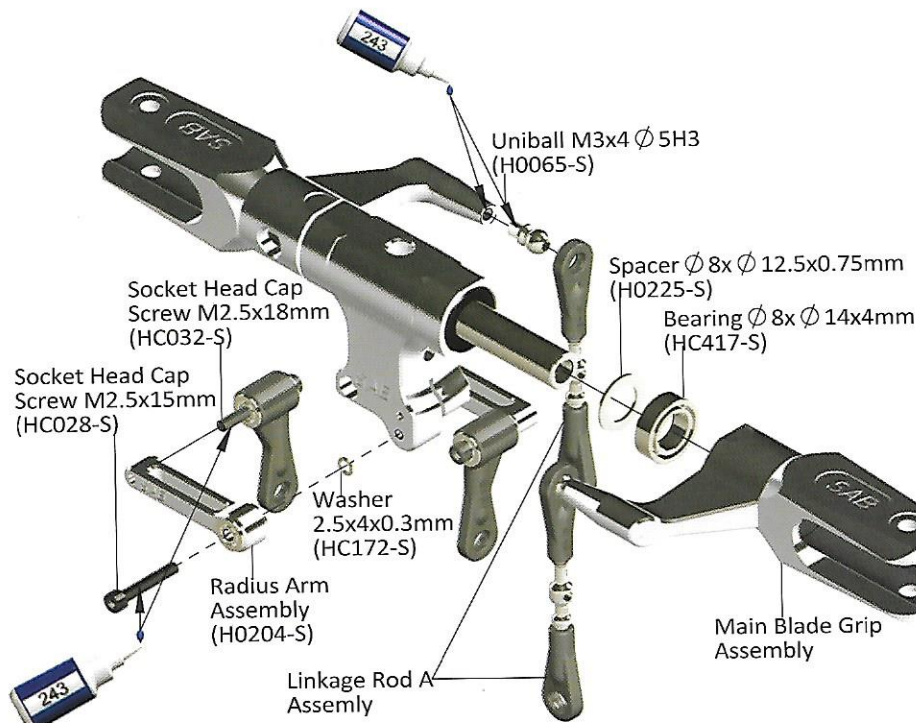
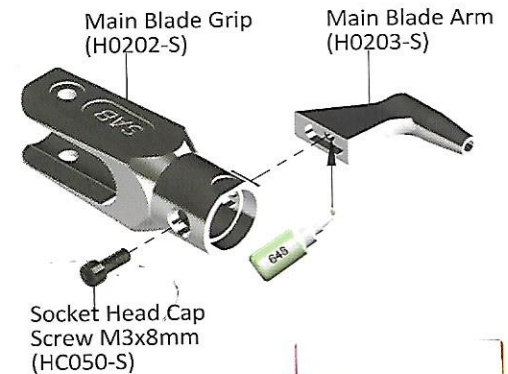

Linkage Rod A Assemblyx2

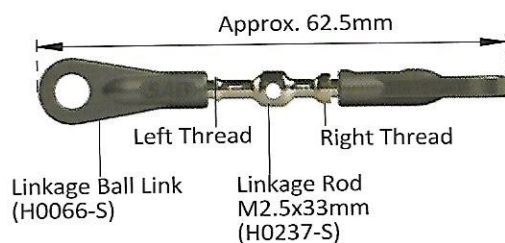

Button Head Cap Screw M6x10mm



Socket Head Cap Screw M3x8mm



Socket Head Cap Screw M2.5x15mm



Socket Head Cap Screw M2.5x18mm



Note: Please add thread
locker to the M6x10 Screws

(Initial length for the rods from the swashplate