

Tail Control Rod Assembly

Note - Tail push rod ends will slide through tail control guides.

Note - Lightly sand carbon tail control rod prior to securing with JB Weld:

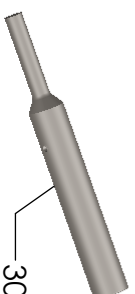

IMPORTANT! - Tail Control Rod End must be secured with high quality glue such as JB Weld. We highly recommend long curing formulas for the best results. Do not use CA for this application! You will encounter failures!

